



Model: _____

Item #: _____ Quantity: _____

Project: _____



Liquor Display

- **Bottle Steps:**
20 gauge embossed stainless steel.
- **Guardrails:**
20 gauge stainless steel with sound deadened plastic.
- **Backsplash:**
22 gauge stainless steel.
- **Sides:**
18 gauge stainless steel.
- **Back:**
20 gauge galvanized.
- **Legs:**
1 5/8" tubular 16 gauge galvanized steel with grey plastic bullet foot.

Cabinet

- **Sink Bowl:**
20 gauge stainless steel.
10" x 14" x 6" deep with drain.
- **Drainboard:**
20 gauge stainless steel.
- **Front Apron:**
24 gauge stainless steel.
- **Backsplash:**
22 gauge stainless steel.
- **Sides:**
18 gauge stainless steel.
- **Back:**
20 gauge galvanized.
- **Bottom:**
20 gauge stainless steel.
- **Legs:**
1 5/8" tubular 16 gauge galvanized steel with grey plastic bullet foot.
- **Plumbing:**
1 1/2" IPS drain connection.
- **Water Faucet:**
4" center splash mount faucet on 1800 models.
4" center deck mount faucet on 2100 models.

Accessories

- Stainless Steel Locking Cover (for Liquor Display).
- Perforated Dump Box (Cabinet).
- Stainless Steel Legs
- Royal Faucet (Upgrade)

Approved By: _____

Model: _____ Item #: _____ Quantity: _____ Project: _____

1800 Series

Liquor Display

Model Number	Length	Steps	Number of Bottles (approx.)	Weight lbs.
18-24RD	2'-0"	4	30	35

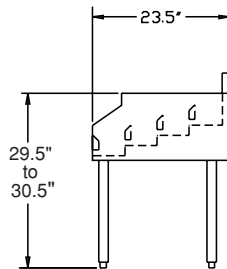
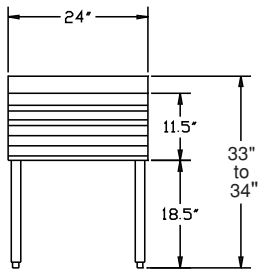
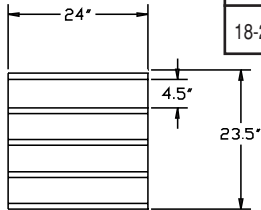

Glass Washing Cabinet

Model Number	Length	Top	Weight lbs.
18-GW2	2'-0"	DRBD	35

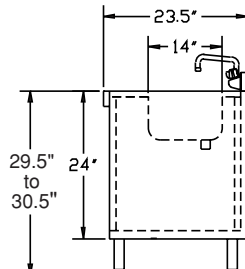
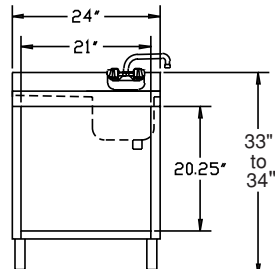
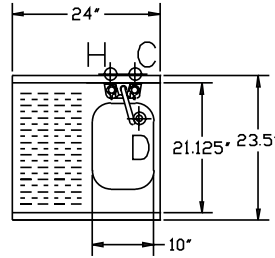

2100 Series

Liquor Display

Model Number	Length	Steps	Number of Bottles (approx.)	Weight lbs.
21-24RD	2'-0"	4	30	35

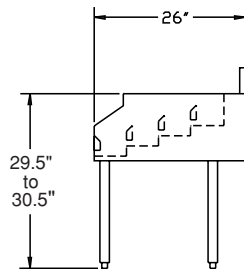
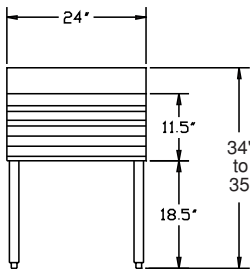
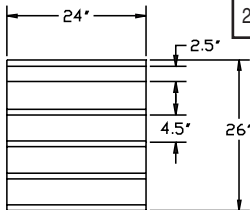

Glass Washing Cabinet

Model Number	Length	Top	Weight lbs.
21-GW2	2'-0"	DRBD	35

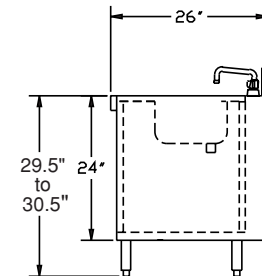
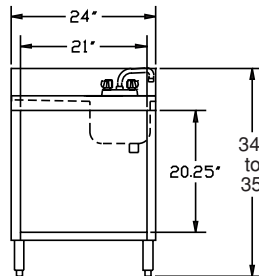
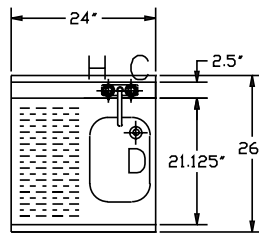

Mechanical Requirements:
1 1/2" IPS drain connection (on cabinet)

Approved By: _____

Due to our commitment to continued product improvement, specifications are subject to change without notice.